



**Town of Coventry
Building Inspections Office
SITE PLAN FORM AFFIDAVIT (1 of 2)**

I _____ affirm that the site plan accompanying this building permit application was prepared by:

A licensed R.I. Professional Engineer or Land Surveyor as identified on the site plan; or by

The applicant after reference to all applicable land evidence records for the property as recorded in the Coventry Town Clerk's Office (e.g. deeds, development plans, decisions of record, easements, rights-of-way, etc.).

I represent that all measurements, distances and areas shown on the site plan are true and accurate and I assume full responsibility for any inaccuracies contained therein.

I understand that if any measurements or dimensions shown on the site plans are later found to be incorrect, the Town may revoke any permit or approval issued in reliance on the site plan and require the removal of any structure built pursuant to that permit or approval.

I understand that filing a false document with a public official is a criminal misdemeanor in R.I. punishable by a year in prison or a \$1,000 fine. R.I. General Laws §11-18-1.

X _____
Owner / Contractor

SITE PLAN FORM (2 of 2)

- ❖ Setback lines are for current residence.
- ❖ Add your accessories structure to be permitted and to include its setback.

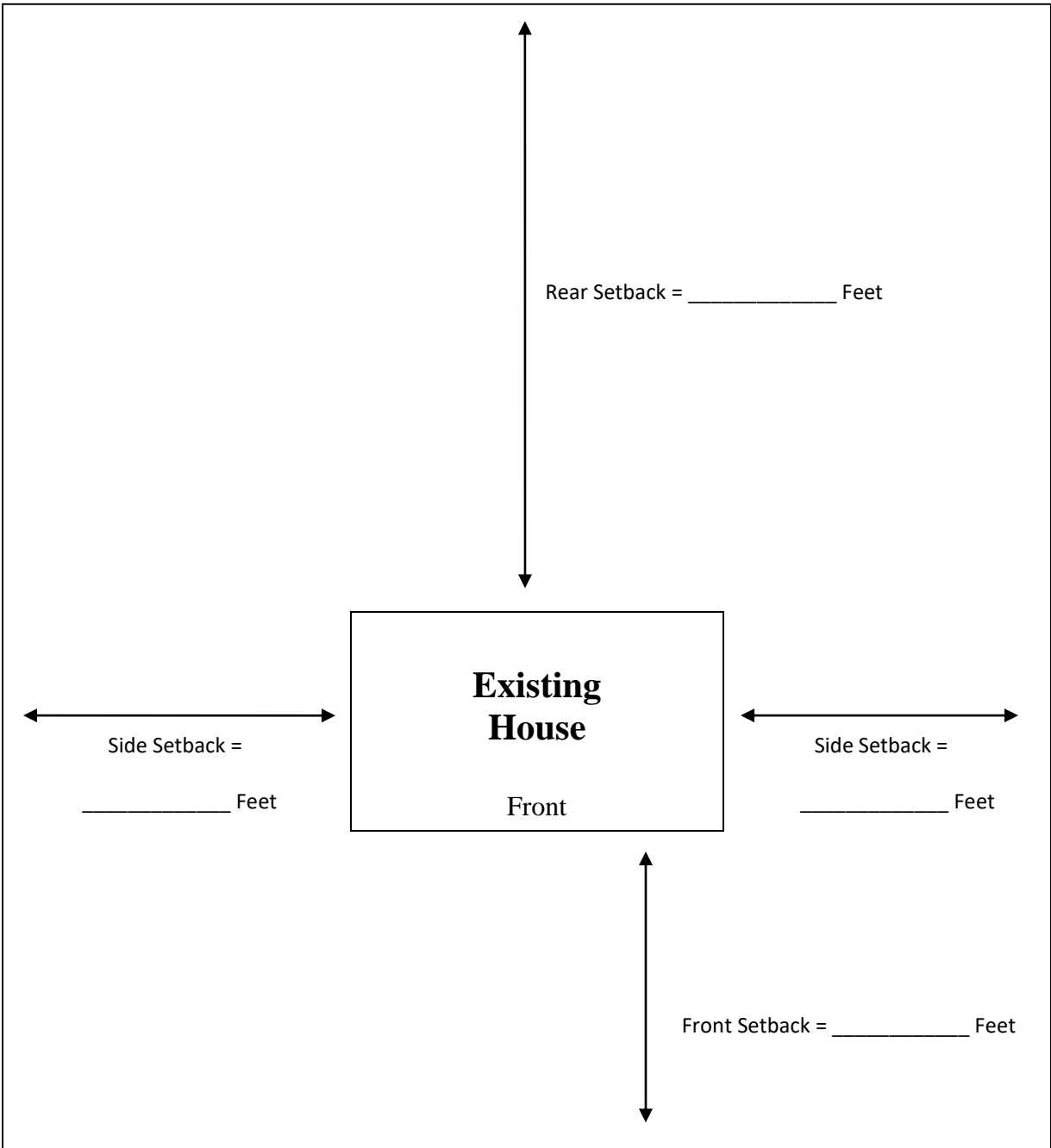

*Property Address:	
Plat:	Lot:
Zoning District:	
*Signature:	*Date:

* The information must be filled out.